

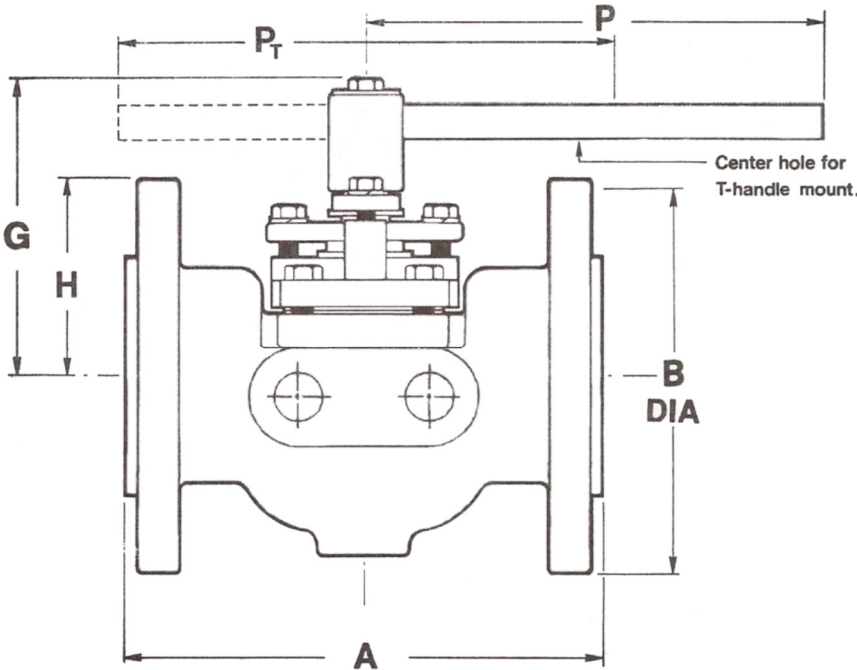

JACKETED SLEEVED PLUG VALVES

1/2" x 1" - 4" x 6"

models V022 & V322



PRESSURE-TEMPERATURE RATINGS		
MODEL	CLASS	RATING
V023	150 LB.	180 PSI@400° F.
V323	300 LB.	400 PSI@400° F.

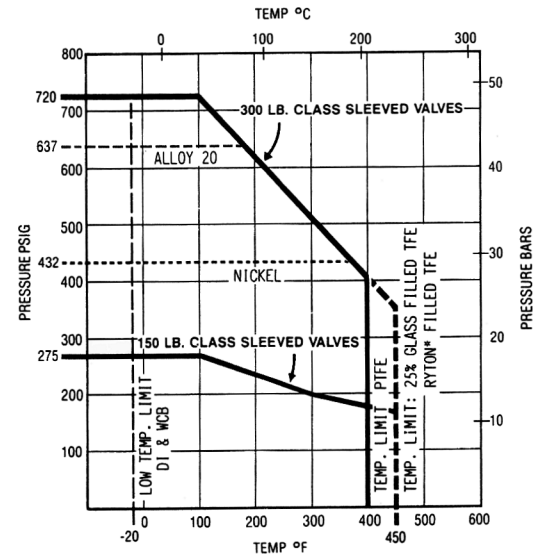

DIMENSIONS and WEIGHTS

Dimensions and weight may vary—apply for certified drawings.

SIZE	150lb. 300 lb.	Flange Holes	A	B	G	H	P	P _T	Weight
1/2 x 1	V023	4 .625 3.125	5	4-1/4	4-9/16	2-1/4	8	8-1/2	14
	V323	4 .750 3.500	5-1/2	4-7/8	4-9/16	2-9/16	8	8-1/2	18.3
3/4 x 1-1/2	V023	4 .625 3.875	6-1/2	5	4-9/16	2-3/4	8	8-1/2	20
	V323	4 .875 4.500	7	6-1/8	4-9/16	3-1/4	8	8-1/2	28.4
1 x 2	V023	4 .750 4.750	7	6	4-11/16	3-1/8	8	8-1/2	27
	V323	8 .750 5.000	7-1/2	6-1/2	4-11/16	3-3/8	8	8-1/2	33.4
1-1/2 x 2-1/2	V023	4 .750 5.500	7-1/2	7	6-5/16	3-5/8	14	14-7/8	37
	V323	8 .875 5.875	8-1/8	7-1/2	6-5/16	3-7/8	14	14-7/8	46.8
2 x 3	V023	4 .750 6.000	8	7-1/2	6-5/8	3-3/4	14	14-7/8	46.5
	V323	8 .875 6.625	8-3/4	8-1/4	6-5/8	4-1/8	14	14-7/8	61.2
3 x 4	V023	8 .750 7.500	9	9	7-1/4	4-1/2	23	23-7/8	60
	V323	8 .875 7.875	9-5/8	10	7-1/4	5	23	23-7/8	81.4
4 x 6	V023	8 .875 9.500	10-1/2	11	6-9/16*	5-1/2	24**	25**	109+
	V323	12 .875 10.625	11-3/8	12-1/2	6-9/16*	6-1/4	24**	25**	152.4+

* G measured to the top of the plug shaft.
 ** Gear operator recommended for 4" size and larger.
 + Valve only. Add 38 lb. for gear operator.

SERVICE RECOMMENDATIONS

Chem-Plug® sleeve type jacketed valves are designed for chemical service where absolute control of fluids is required within a specified temperature range. With special preparation these valves can be used for severe and hazardous chemical service.

FEATURES

Chem-Plug® models V023 and V323 valves are designed for 150 lb. and 300 lb. ANSI specifications respectively for temperatures ranging from -20°F to 400°F. The bidirectional flow allows more latitude in the design and installation of piping systems. The V023 and V323 valves have a true stuffing box for top seal packing and gland adjustment to reduce leakage by the stem to zero when properly adjusted and maintained. Chem-Plug® sleeved valves with V-ring top seals are adjusted at the factory to hold one and one half times the rated pressure of the valve.

Packing can be adjusted to compensate for normal wear. Like all Chem-Plug® valves, the plug can be adjusted separately from the top seal so that the packing does not have to be readjusted.

The packing can be serviced or replaced without removing the valve from the line.

The solid sleeve is compression molded in virgin PTFE and then sintered. Ryton-filled PTFE is also available. This method provides optimum density which minimizes chemical permeation.

Raised sealing rings are cast 360° around the ports for positive in-line sealing. Blow-out lips are cast adjacent to the port openings to prevent sleeve rotation and reduce cold sleeve flow.

The plug is grounded through the thrust washer and plug adjuster.

All flanged Chem-Plug® valves meet the face-to-face specifications of API 6D (short pattern), API gate valve standard, ANSI B16.10, and ANSI 16.34.

OPERATORS

Wrench operators are standard on all sizes through 3"; manual gear operators are recommended on 4" and 6" sizes. Cast mounting pads are provided on the flanges for rigid mounting of pneumatic, hydraulic, and electric actuators. The pads can be drilled and tapped when specified.

TESTING

Each Chem-Plug® valve is tested for seat leakage and shell integrity according to API Standard 598.



A Unit of Southern Manufacturing Group, Inc.
 7693 Manchester Hwy. Morrison, TN 37357

Ph. (931) 668-5377 Fax (931) 668-5378 Email sales@smg-global.com Web Site www.smg-global.com

BILL OF MATERIALS

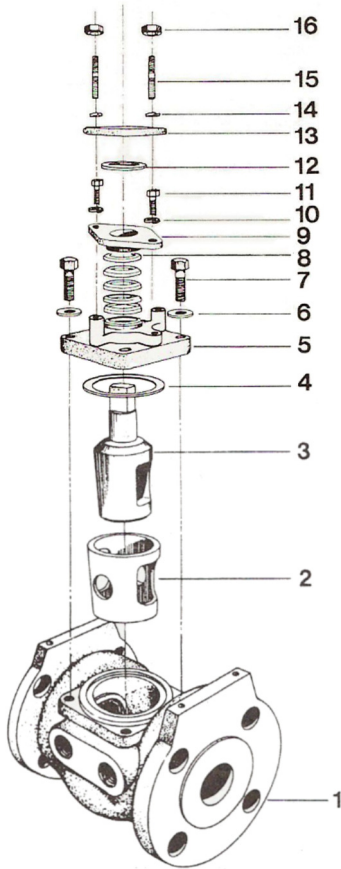

PART NO.	PART	DUCTILE IRON	CARBON STEEL	OTHER ALLOYS
1	BODY	D.I.A. 395	WCB	AS SPECIFIED
2	SLEEVE	PTFE	PTFE	PTFE
3	PLUG	D.1./ ENP	D.1./ ENP	AS SPECIFIED
4	COVER GASKET	PTFE	PTFE	PTFE
5	COVER	D.I.A. 395	WCB	AS SPECIFIED
6	LOCK WASHER	STEEL	STEEL	STAINLESS STEEL
7	COVER BOLT	B7 STEEL	B7 STEEL	STAINLESS STEEL
8	V-RING PACKING	PTFE	PTFE	PTFE
9	PACKING GLAND	D.I.A. 395	WCB	STAINLESS STEEL
10	LOCK WASHER	STEEL	STEEL	STAINLESS STEEL
11	GLAND SCREW	STEEL	STEEL	STAINLESS STEEL
12	THRUST DISC	CARBON STEEL	CARBON STEEL	CARBON STEEL
13	PLUG ADJUSTER	WCB	WCB	AS SPECIFIED
14	LOCK WASHER	STEEL	STEEL	STAINLESS STEEL
15	ADJUSTER STUD	STEEL	STEEL	AS SPECIFIED
16	HEX NUT	STEEL	STEEL	STAINLESS STEEL

MODEL NUMBER CODES

ANSI Class	PORTS	DESIGN and END CONNECTION
V0 = 150 Lb.	2 = 2 Way	1 = Lined Flanged End
V3 = 300 Lb.	3 = 3 Way	2 = Sleeved Flanged End
		3 = Sleeved Flanged End, Jacketed
		4 = Sleeved Screwed End
		5 = Sleeved Socket Weld

MATERIAL CODES

BODY MATERIAL	PLUG MATERIAL	SLEEVE MATERIAL	OPERATORS
H = Ductile Iron	V = Ductile Iron ³	F = PTFE	0 = None
J = Steel, WCB	K = SS, CF8	R = Ryton*	1 = Wrench
K = SS, CF8	L = SS, CF8M	U = UHMWPE	2 = Gear, Manual
L = SS, CF8M	M = CD4MCU	T = Glass filled TFE	3 = Electric
M = CD4MCU	N = Alloy 20	S = Special	4 = Pneumatic
N = Alloy 20	P = Monel		5 = Hydraulic
P = Monel	Q = Hastelloy B		6 = Special
Q = Hastelloy B	R = Hastelloy C		7 = Wrench with locking device
R = Hastelloy C	Y = Inconel		8 = Gear with locking device
Y = Inconel	S = Special		9 = Gear with chain wheel
S = Special			

SPECIAL FEATURES

O = None
 FS= Grafoil top seal
 Fire safe (V series)
 EP= Epoxy Coated
 X = Other (specify)**

* Phillips Petroleum Trademark
³ Electroless Nickel Plated

** Give complete, accurate description of the special feature when ordering.

Example of Ordering Code:

V023-JLF1-0

This is an example of a V-ring top seal, 150lb. ANSI, 2 Way, sleeved, flanged end jacketed plug valve with a carbon steel body, stainless steel plug, PTFE sleeve, wrench operator, and no special features