

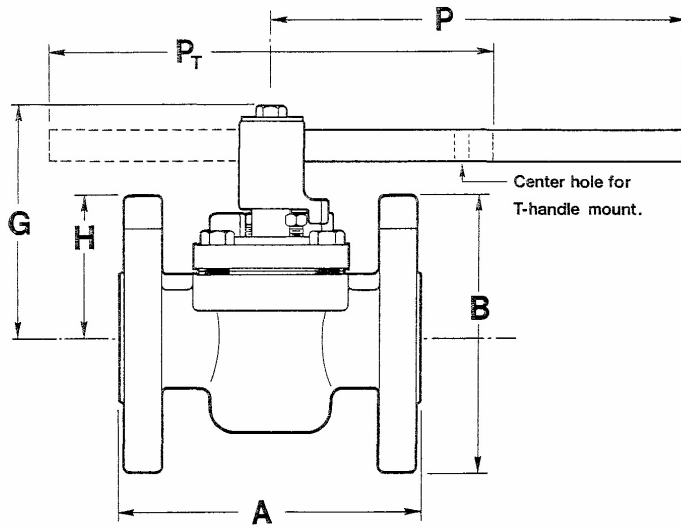

SLEEVED PLUG VALVES

1/2" - 12"

models 022 & 322



DIMENSIONS and WEIGHTS

Dimensions and weight may vary—apply for certified drawings.

SIZE	150	Flange Holes		A	B	G	H	P	Pt	Weight
	300	No.	Size							
1/2	022	4	.625 2.375	4-1/4	3-1/2	3-7/8	1-15/16	8	8-1/2	7
	322	4	.625 2.625	5-1/2	4-5/8	3-7/8	2-3/8	8	8-1/2	10
3/4	022	4	.625 2.750	4-5/8	3-7/8	3-7/8	2-1/8	8	8-1/2	8
	322	4	.750 3.250	6	4-5/8	3-7/8	2-3/8	8	8-1/2	11
1	022	4	.625 3.125	5	4-1/4	4	2-1/4	8	8-1/2	9
	322	4	.750 3.500	6-1/2	4-7/8	4	2-9/16	8	8-1/2	12
1-1/2	022	4	.625 3.875	6-1/2	5	5-5/8	2-3/4	14	14-7/8	17.5
	322	4	.875 4.500	7-1/2	6-1/8	5-5/8	3-1/4	14	14-7/8	24
2	022	4	.750 4.750	7	6	6	3-1/8	14	14-7/8	23
	322	8	.750 5.000	8-1/2	6-1/2	6	3-3/8	14	14-7/8	29
3	022	4	.750 6.000	8	7-1/2	6-5/8	3-3/4	23	23-7/8	36
	322	8	.875 6.625	11	8-1/4	6-5/8	4-1/8	23	23-7/8	49.5
4	022	8	.750 7.500	9	9	6*	4-1/2	24**	25**	57+
	322	8	.875 7.875	12	10	6*	5	24**	25**	84+
6	022	8	.875 9.500	10-1/2	11	7-5/16*	5-1/2	**	**	110+
	322	12	.875 10.625	15-7/8	12-1/2	7-5/16*	6-1/4	***	**	162+

For 8", 10" and 12" see models V022 and V322

* G measured to the top of the plug shaft.

** Gear operator recommended for 4" size and larger.

PRESSURE-TEMPERATURE RATINGS		
MODEL	CLASS	RATING
022	150 LB.	150 PSI@400° F.
322	300 LB.	300 PSI@400° F.

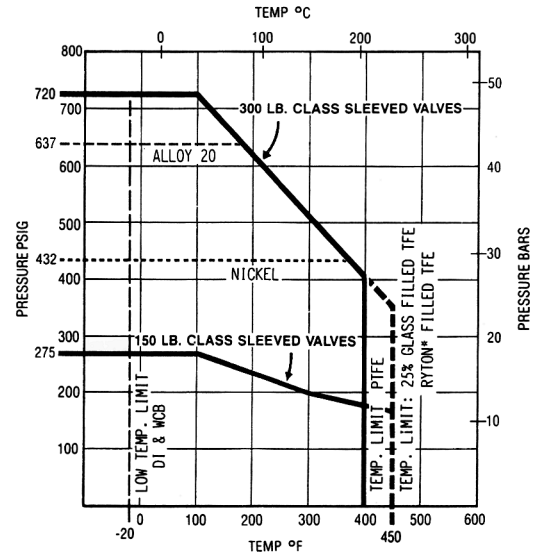

SERVICE RECOMMENDATIONS

Chem-plug[®] sleeved valves have been designed for general use in process industries, pharmaceuticals, pulp and paper, textiles, water treatment plants, and similar applications.

FEATURES

Chem-plug[®] model 022 and 322 valves are designed for 150 Lb. ANSI and 300 Lb. class ANSI applications respectively and for temperatures ranging from -20°F to 400°F. The bi-directional flow allows more latitude in the design and installation of piping systems.

The self energizing diaphragm top seal provides positive stem sealing. Due to a unique hot forming process, a long service life is assured. The uniform film thickness of the PFA diaphragm offers greater resistance to chemical permeation and absorption than other designs.

The solid sleeve is compression molded in virgin PTFE (Ryton available) and then sintered. This method of manufacture provides optimum density which minimizes chemical permeation.

Raised sealing rings are cast 360° around the ports for positive in-line sealing under pressure, vacuum, and temperature cycling.

Blow-out lips are cast adjacent to the port openings to prevent sleeve rotation and reduce sleeve cold flow. The plug can be adjusted to stop internal leakage due to normal wear. A grounding spring is provided to safely dissipate any electrical charge that might build up on the plug.

All flanged Chem-plug[®] valves meet the face-to-face specifications of API 6D (short pattern), API gate valve standard, ANSI B16.10, and ANSI B16.34.

OPERATORS

Wrench operators are standard on all sizes through 3" ; manual gear operators are recommended on 4" and 6" sizes. Cast mounting pads are provided on the flanges for rigid mounting of pneumatic, hydraulic, and electric actuators. The pads can be drilled and tapped when specified.

TESTING

Each Chem-plug[®] valve is tested for seat leakage according to API Standard 598.



A Unit of Southern Manufacturing Group, Inc.
7693 Manchester Hwy. Morrison, TN 37357
Ph. (931) 668-5377 Fax (931) 668-5378

Email sales@smg-global.com Web Site www.smg-global.com

BILL OF MATERIALS

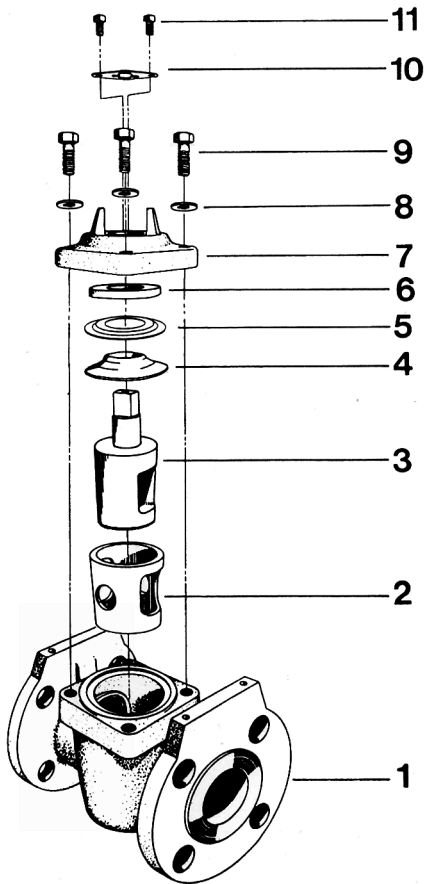

PART NO.	PART	DUCTILE IRON	CARBON STEEL	OTHER ALLOYS
1	BODY	D.I.A. 395	WCB	AS SPECIFIED
2	SLEEVE	PTFE	PTFE	PTFE
3	PLUG	D.I./ ENP	D.I./ ENP	AS SPECIFIED
4	DIAPHRAGM	PFA	PFA	PFA
5	METAL DIAPHRAGM	304 SS	304 SS	304 SS
6	THRUST DISC	STAINLESS STEEL	STAINLESS STEEL	STAINLESS STEEL
7	COVER	D.I.A. 395	D.I.A. 395	316 SS
8	LOCK WASHER	STEEL	STEEL	STAINLESS STEEL
9	COVER BOLT	B7 STEEL	B7 STEEL	STAINLESS STEEL
10	GROUNDING SPRING	302 SS	302 SS	302 SS
11	ADJUSTMENT SCREW	STEEL	STEEL	STAINLESS STEEL

MODEL NUMBER CODES

MATERIAL CODES

SPECIAL FEATURES

ANSI Class	PORTS	DESIGN and END CONNECTION	BODY MATERIAL	PLUG MATERIAL	SLEEVE MATERIAL	OPERATORS	SPECIAL FEATURES
0 = 150 Lb. 1 = 300 Lb.	2 = 2 Way 3 = 3 Way	1 = Lined flanged end 2 = Sleeved flanged end 3 = Sleeved flanged end, jacketed 4 = Sleeved screwed end 5 = Sleeved socket weld end	H = Ductile Iron J = Steel, WCB K = SS, CF8 L = SS, CF8M M = CD4MCU N = Alloy 20 P = Monel Q = Hastelloy B R = Hastelloy C Y = Inconel S = Special	V = Ductile Iron ³ K = SS, CF8 L = SS, CF8M M = CD4MCU N = Alloy 20 P = Monel Q = Hastelloy B R = Hastelloy C Y = Inconel S = Special	F = PTFE R = Ryton* U = UHMWPE T = Glass filled TFE	0 = None 1 = Wrench 2 = Gear, Manual 3 = Electric 4 = Pneumatic 5 = Hydraulic 6 = Special 7 = Wrench with locking device 8 = Gear with locking device 9 = Gear with chain wheel	O = None DT = Drilled, Tapped for actuators DB = Double block and bleed CH = Chlorine prepared OX = Oxygen prepared FS = Grafoil top seal ire safe (V series) EP = Epoxy coated PH = Relief holes in plug (specify) X = Other (specify)

* Phillips Petroleum Trademark ** Give a complete, accurate description of the special feature when ordering.
3 Electroless nickel plated

Example of Ordering Code:

022 - JLF1 - 0

This is an example of a diaphragm top seal, 150Lb. ANSI, 2 Way, flanged end, sleeved plug valve with a carbon steel body, stainless steel plug, PTFE sleeve, wrench operator, and no special features.